

## 3-WAY BALL VALVE FLANGED

DN15-DN50 PN10/40  
DN65-DN80 PN10/40



### Description

- DN15-DN50 PN10/40
- DN65-DN80 PN10/40
- 3-Way flanged ball valve
- TA-LUFT design approved
- Built-in ISO5211 direct Mounting Pad for easy automation
- quality and precision castings flowing ball valve
- full bore
- blow-out proof stem

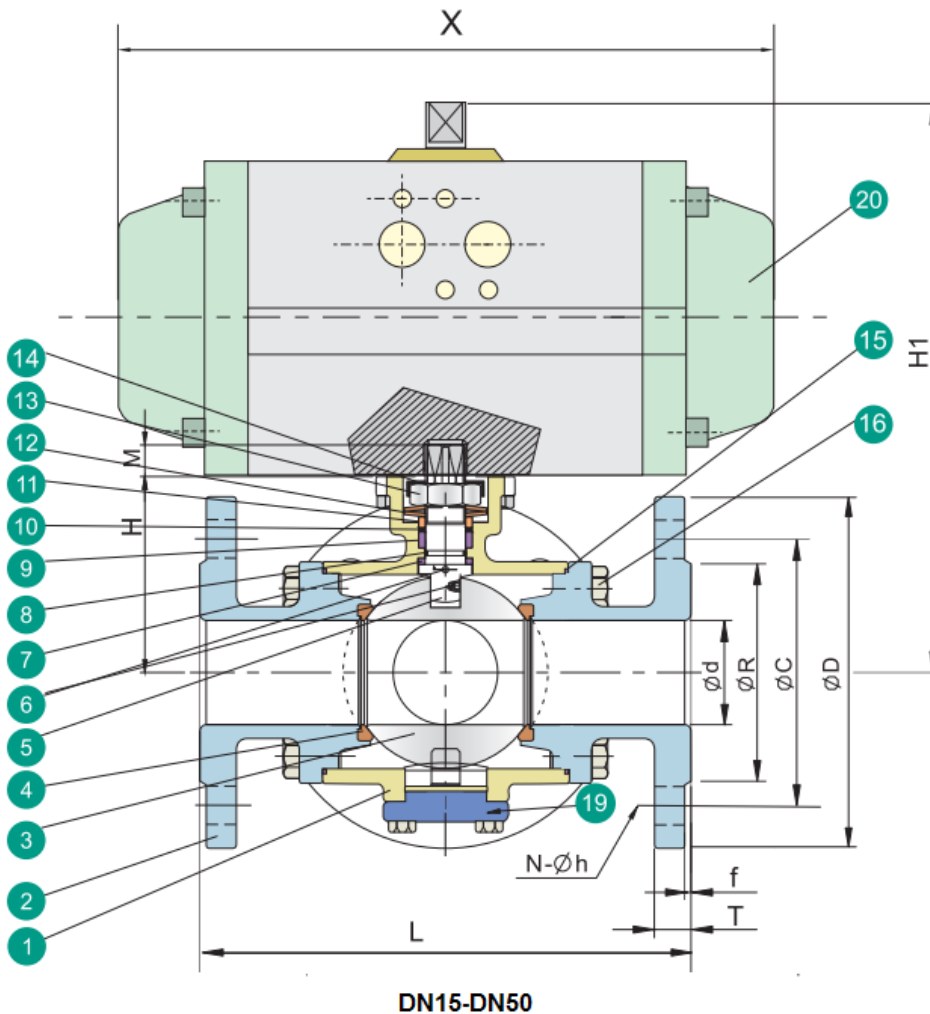

## 3-WAY BALL VALVE FLANGED

DN15-DN50 PN10/40  
 DN65-DN80 PN10/40

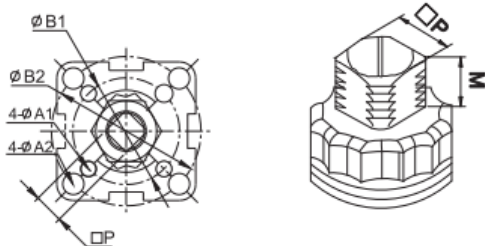
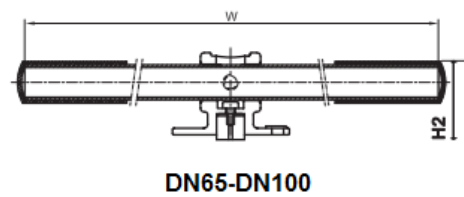
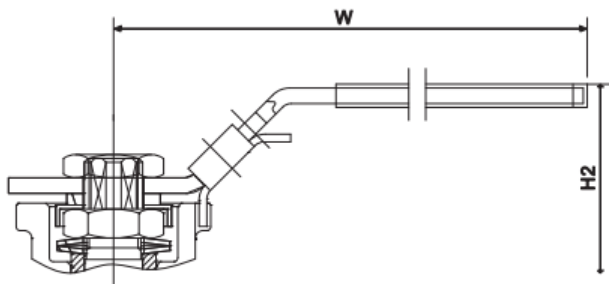
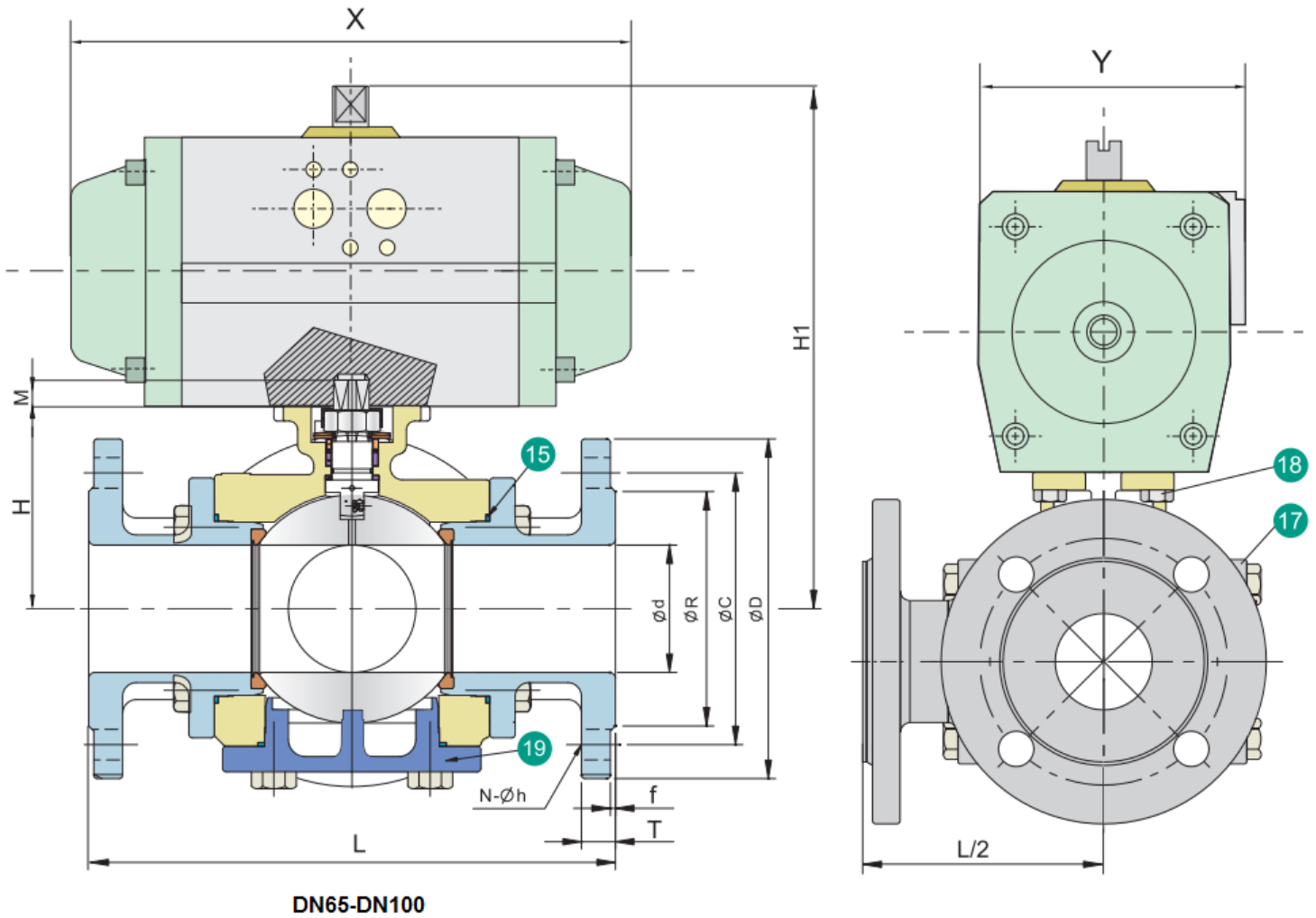

## 3-WAY BALL VALVE FLANGED

DN15-DN50 PN10/40  
DN65-DN80 PN10/40

### Sizes

DN	PN	ød	L	R	D	C	f	T	H	H1	H2
15	10~40	15	150	45	95	65	2	16	52,5	150	83,3
20	10~40	20	165	58	105	75	2	18	57	155,5	87
25	10~40	25	181	68	115	85	2	18	68	198	99
32	10~40	32	190	78	140	100	2	18	72	205,5	103
40	10~40	38	212	88	150	110	3	18	85	228,5	119
50	10~40	49	230	102	165	125	3	20	92	234	126
65	10/16	63	290	122	185	145	3	18	107	261	172
	22										
80	10/16	75	310	138	200	160	3	20	119	273	187
	25/40		340					24			
100	10/16	99	350	158	220	180	3	20	150	345	214
	25/40		386					162			

DN	W	N	øh	P	M	ØA1	ØA2	ØB1	ØB2	X	Y	ISO5211
15	144,5	4	14	9	9	6	6	36	42	144	72	F03-F04
20	144,5	4	14	9	9	6	7	36	50	144	72	F03-F05
25	175	4	14	11	11	6	7	42	50	164	84	F04-F05
32	175	4	18	11	11	6	9	42	70	164	84	F04-F05
40	200	4	18	14	14	7	9	50	70	228,5	108	F05-F07
50	200	4	18	14	14	7	9	50	70	234	108	F05-F07
65	400	4	18	17	17	9	11	70	102	261	123	F07-F10
		8										
80	400	8	18	17	17	9	11	70	102	314	151	F07-F10
100	400	8	18	22	22	n/a	11	n/a	102	345	151	F10
			22									

### Components

č.	Part name	Material		
1	Body	CF8M	CF8	WCB
2	Cap	CF8M	CF8	WCB
3	Ball	CF8M	CF8	
4	Seat	TFM1600/PTFE		
5	Stem	SUS316	SUS304	
6	Anti-Static Device	SUS316	SUS304	
7	Thrust washer	PTFE		
8	O-Ring	FKM		
9	Stem packing	PTFE		
10	Bushing	50%SS + 50% PTFE		

č.	Part name	Material
11	Gland	SUS316
12	Belleville Washer	SUS301
13	Stem Nut	A194-8
14	Stop-lock-cap	SUS304
15	Body gasket	PTFE
16	Bolt	A193-B8 / A193-B7
17	End Cap	CF8M / CF8 / WCB
18	Hex Bolting	A193-B8 / A193 B7
19	Bottom Cap	CF8M / CF8 / WCB
20	Actuator	Pneumatic/Electric

## 3-WAY BALL VALVE FLANGED

DN15-DN50 PN10/40  
DN65-DN80 PN10/40

### Executions

#### 1) 3-WAY T-PORT

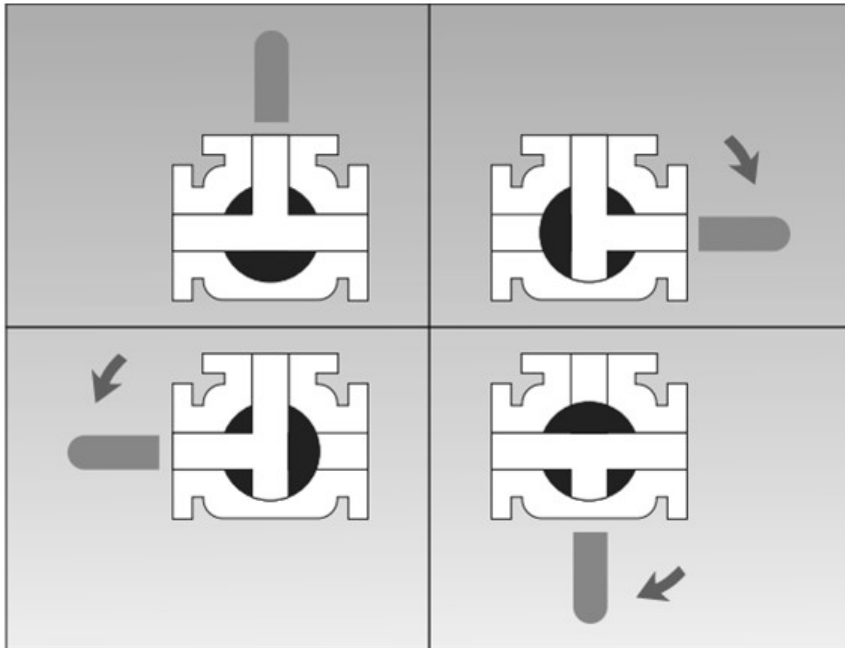

#### 2) 3-WAY L-PORT

