

DIAPHRAGM VALVE TYPE 592 DN 15 - 50



Description

- diaphragm valve with 2 stage-piston-high cycles actuator
- extremely compact construction . actuator dia smaller as diaphragm dia
- actuator is possible to turn 90°C
- outer surface
- CIP+SIP sterilisation surface quality
- position indicator
- flexible diaphragm fixing
- encapsulated diaphragm

Technical parametres

- **Actuator function** NC, NO, DA
- **Maximal working temperature:** upto 160°C
- **Maximal working pressure:**
EPDM diaphragm . 10 bar
PTFE diaphragm . 8 bar
- **Maximal air pressure:** 5 . 8 bar
- **Connection:** buttweld, clamp, flanged

Materials:

- **Diaphragm:** EPDM or PTFE
- **Body:** forged 1.4435/316L
cast 1.4435/316L
(or others optional)

Dimensions (mm)

DN	MA	L	L ₁	A x B	H ₁	H ₂	H ₃	H ₄	H ₅	D
15 - 25	25	25	120	73x79	220	66	150	-	35	75
32 - 40	40	25	153	96x105	260	68	180	34	46	105
50	50	30	173	110x130	280	77	190	34	50	105

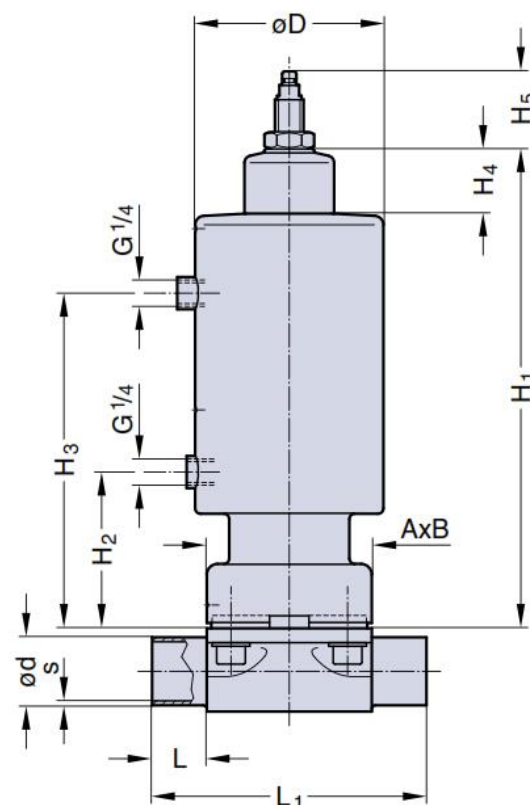

TYPE 407