

MAINTENANCE MANUAL

HIGH PERFORMANCE BALL VALVE

SERIE 90

DN 15 – 200 PN 10/16/40

Montage

In case you are going to assemble ball valve without actuators you may use any position of the valve, if you install the ball valve including the actuator we suggest to use the position – ACTUATOR UPWARDS.

Maintenance

The ball valve series 90 are maintenance-free and when used properly no further maintenance is required. Packing is under constant pressure of springs and therefore is not necessary to tightened.

Repair

When the seats or packings are worn out then need to replace for new one.

Disassembling

When you replace the seat it is sufficient to unscrew the bolts (**No.6**) and separate two halves of the body and remove seats and ball . all in the position . BALL OPENED. When you replace the packing it is necessary to start disassembling from above (from nut . **No.18**) and end with removing of the stem (**No.8**) over the inside the body.

Assembling

Please use the same procedure as you disassemble but proceed from back to front.

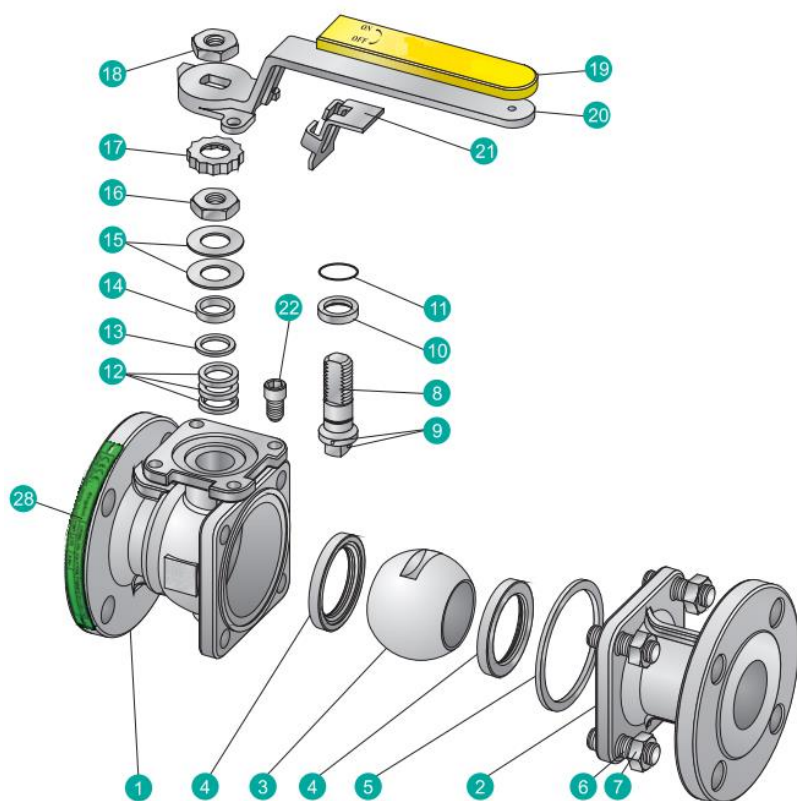

Pos.	Part	Material
1	Body A	A216WCB/AISI316
2	Body B	A216WCB/AISI316
3	Ball	1.4308/1.4408
4	Body gasket	TFM4215
5	Body packing	PTFE
6	Bolting	A193 . B7
7	Bolt nut	A194 . 2H
8	Stem	AISI304
9	Anti-static device	AISI304
10	Thrust washer	PTFE
11	O-ring	Viton
12	Stem packing	PTFE
13	Bushing	50% SS + 50% PTFE
14	Gland	AISI316
15	Belleville washer	AISI301
16	Stem nut	A194-8
17	Stop-lock-cap	AISI304
18	Lever nut	A194-8
19	Lever sleeve	Vinyl
20	Lever	AISI304
21	Locking device	AISI304
22	Triangle stopper	A193-B8
28	Nameplate	AISI304