

METAL DIAPHRAGM VALVE TYPE 985 / 987 2/2 WAY, MANUALLY OPERATED DN15 – DN200

TYP 985 / 987



Construction

985 Handwheel operated diaphragm valve in plastic

987 Handwheel operated diaphragm valve in metal

Construction

- bubble tight sealing
- installation in any position
- compact construction
- easy maintenance
- excellent flow characteristics
- flow can be in either direction
- process media can be neutral and aggressive
- dependent upon material of body and diaphragm

Technical data

Temperature: Type 985 max 95°C, Type 987 max 150°C depending on diaphragm and body

DN	PN	Kv	Face to face DIN 3202							Face to face MSS-SP88			Face to face BS 1516			Threaded Socket 1.4435 or GG25
			GG 25	GG25 Rubber Lined	**GGG 40.3 PFA Lined	**GGG 40.3 PP Lined	**GGG 40.3 PTFE Lined	Stainless Steel	Stainless Steel - PFA Lined	**GGG 40.3 PFA Lined	**GGG 40.3 PP Lined	Stainless Steel	**GGG 40.3 PFA Lined	**GGG 40.3 PP Lined	Stainless Steel	
15	10	7	X		X	X		X				X			X	X
20	10	14	X	X	X	X		X	X	X	X	X	X	X	X	X
25	10	20	X	X	X	X		X	X	X	X	X	X	X	X	X
32	10	36	X	X	X	X		X		X	X	X	X	X	X	X
40	10	40	X	X	X	X		X	X	X	X	X	X	X	X	X
50	10	80	X	X	X	X		X	X	X	X	X	X	X	X	X
65	10	120	X*	X*	X	X		X		X*	X*	X	X*	X*	X	
80	10	160	X	X	X	X		X		X	X	X	X	X	X	
100	10	238	X	X	X	X		X		X	X	X	X	X	X	
125	10	376	X	X			X	X				X			X	
150	10	496	X	X			X	X				X			X	
200	6	910	X	X			X	X				X			X	

* = always with handwheel operated actuator metall type 987

** = ductile iron

METAL DIAPHRAGM VALVE 2/2 WAY, MANUALLY OPERATED TYPE 985 / 987 DN15 - DN200

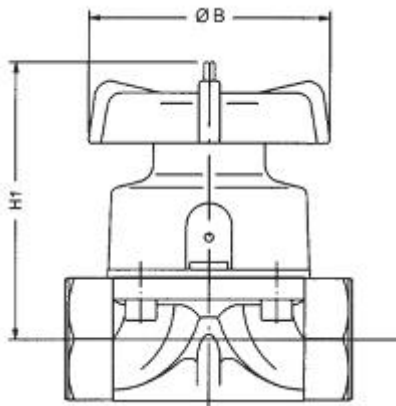

TYPE 985

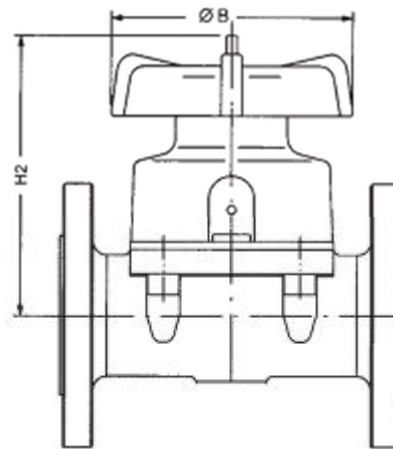

TYPE 985

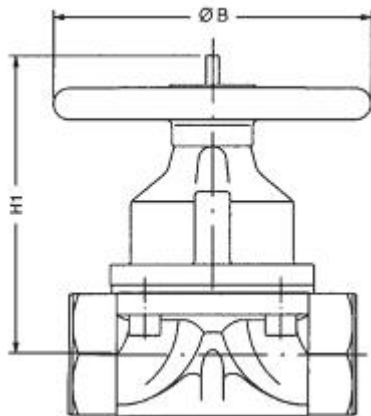

TYPE 987

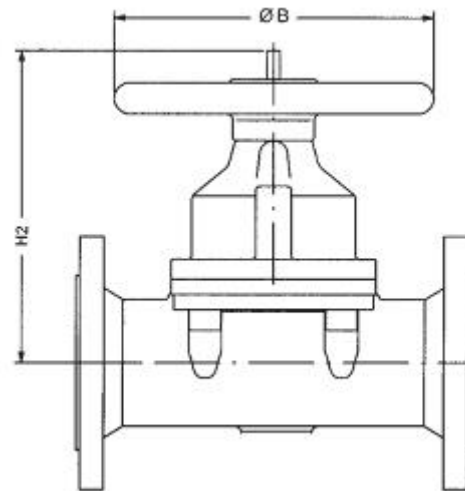

TYPE 987

DN	Type 987 with Flange			Type 985 with Flange			Type 985 with Threaded Socket		Type 985 with Threaded Socket	
	ØB	H2	kg	ØB	H2	kg	H1	kg	H1	kg
15	100	111	3,0	90	105	1,7	102	1,5	96	0,6
20	100	111	3,6	90	105	2,9	105	1,6	99	1,1
25	100	115	4,5	90	109	3,8	109	1,8	103	1,6
32	140	157	7,0	115	128	5,4	153	3,0	124	2,6
40	140	163	8,0	115	134	6,5	156	4,0	127	3,5
50	140	176	11,3	140	169	8,5	172	6,0	165	5,6
65	225	258	19,0	250	284	15,0				
80	225	258	20,3	250	300	16,5				
100	225	292	33,0	250	332	23,8				
125	310	416	76,0							
150	368	427	80,0							
200	471	581	160,0							