

## BALL VALVE WITH LINING TYPE CPL DN15 – 150 PN10/16



### Features

- Two-piece ball valve made of GGG 40.3
- Lining made of PFA, FEP, PP, ETFE or PVDF with minimal thickness 3 mm.
- cylinder made of stainless steel 1.4435, titanium, monel, hastelloy or stainless steel with coating made of PFA, FEP, PP, ETFE or PVDF
- flange acc to ISO 5211

### Advantages

- full bore without death space
- gas tightness at full pressure and temperature
- high tightness by the stem

### Operating

- hand lever
- gearbox
- electro actuator
- pneumatic actuator

### Parameters

- Temperatures from -40°C to 200°C, see the chart below

### PRESSURE

### VACUUM

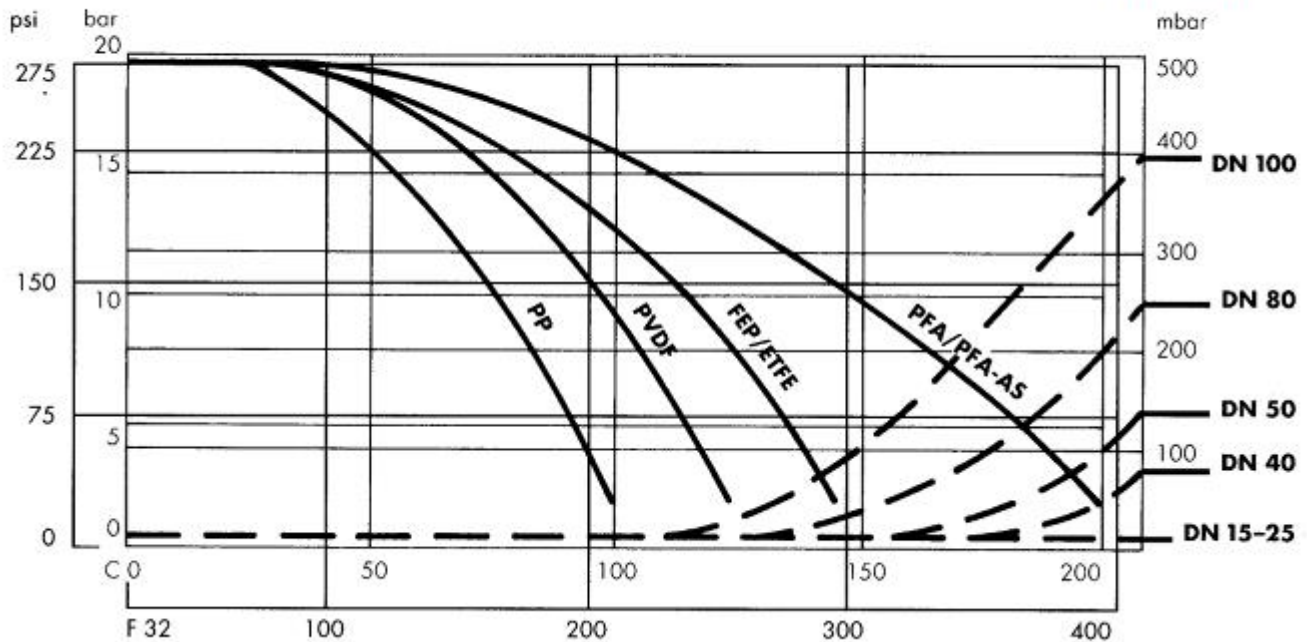

## BALL VALVE WITH LINING TYP CPL DN15 – 150 PN10/16

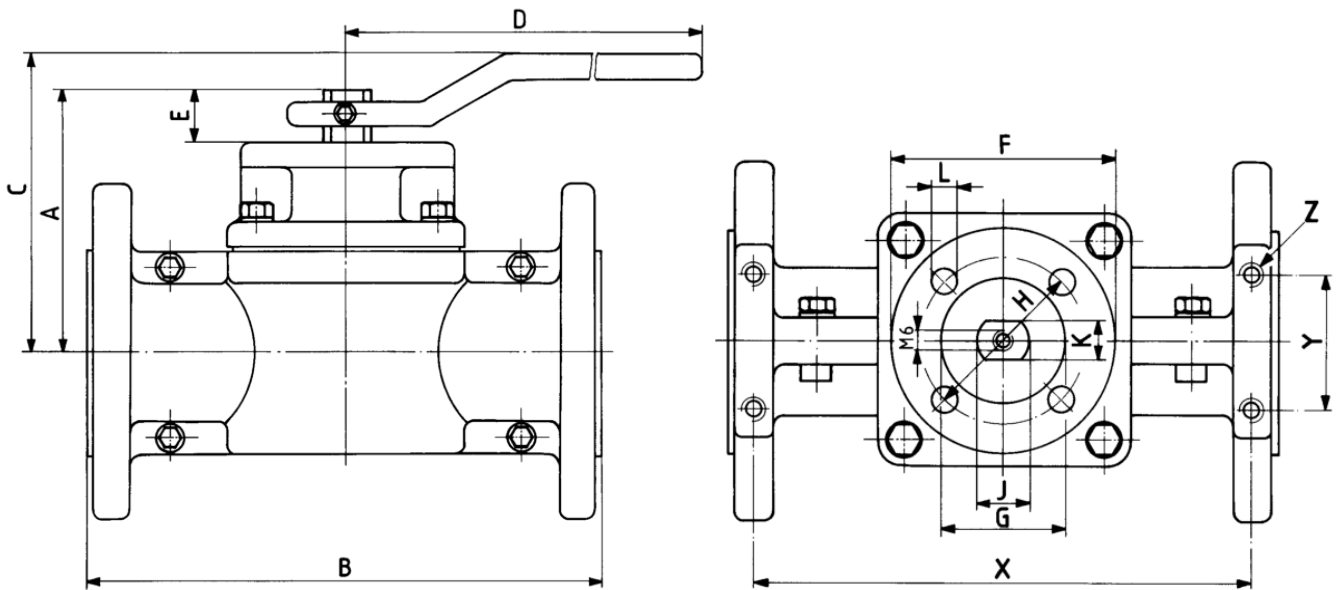

### Dimensions (mm)

| DN  | A      | B   | C      | D   | ISO | E  | F  | G  | H  | J  | K  | K | kg    |
|-----|--------|-----|--------|-----|-----|----|----|----|----|----|----|---|-------|
| 15  | 90,00  | 130 | 115,00 | 250 | F05 | 19 | 65 | 35 | 35 | 14 | 10 | 7 | 3,60  |
| 20  | 92,50  | 150 | 117,50 | 250 | F05 | 19 | 65 | 35 | 35 | 14 | 10 | 7 | 4,20  |
| 25  | 95,00  | 160 | 120,00 | 250 | F05 | 19 | 65 | 35 | 35 | 14 | 10 | 7 | 4,80  |
| 40  | 101,00 | 200 | 136,00 | 280 | F05 | 19 | 65 | 35 | 35 | 18 | 13 | 7 | 7,90  |
| 50  | 107,50 | 230 | 142,50 | 280 | F05 | 19 | 65 | 35 | 35 | 18 | 13 | 7 | 10,30 |
| 80  | 145,00 | 310 | 190,00 | 400 | F07 | 24 | 90 | 90 | 55 | 24 | 17 | 9 | 23,50 |
| 100 | 171,00 | 350 | 216,00 | 400 | F07 | 24 | 90 | 90 | 55 | 24 | 17 | 9 | 32,50 |
| 150 | 171,00 | n/a | 216,00 | 400 | F07 | 24 | 90 | 90 | 55 | 24 | 17 | 9 | 35,50 |